



Thousand Hundred Industrial CO.,LTD.

Customer Part No.		Date Of Issue:	
T.H. Part No.	RCCxxxHxxxxx	T.H. Sample No.	

Product Appearance:



- Rogowski coil
- 5A output Integrator
- Switch Mode Power Supply (SMPS)

Introduction:

Rogowski coil has the advantages of wide bandwidth, good accuracy (typically 1%) and large input current range. The frequency of measuring current can be several Hz up to tens of MHz and mA to KA current measuring range.

The main features include: easy installation with compact and lightweight coils especially for measuring very large currents, non-intrusive-loading the circuit under testing by only a few pH and no danger from open-circuit secondary.

If the specification below does not meet your requirements, please contact us for customization Rogowski coils.

Advantages

- Simple installation (especially in limited space).
- Wide dynamic current range.
- No magnetic saturation.
- No open circuit or overload danger.
- Wide bandwidth.
- Low current measurable.
- High protection class IP65.

Applications

- Power meters.
- Energy sub-meters.
- Power quality monitoring.
- Condition monitoring.
- Distributed measurement systems.
- Lighting current.
- Electric furnace.
- Harmonic management.
- Relay Protection.

China:

Address: No.8, Donghuan 4th St., Jintigang, Huangjiang Town,
Dongguan City, Guangdong, China
Tel: +86-769-83367090 Fax: +86-769-83367590
E-mail: sales.cn@thic.net www.thic.net

Taiwan:

Address: No. 9, Aly. 29, Ln. 335, Chenggong Rd., Hukou Township,
Hsinchu County, Taiwan
Tel: +886-3-5994440 Fax: +886-3-5902243
E-mail: top-th@thic.net www.thic.net



Thousand Hundred Industrial CO.,LTD.

Customer Part No.		Date Of Issue:	
T.H. Part No.	RCCxxxHxxxxx	T.H. Sample No.	

Performance Characteristics (@ $f_{ip}=50\text{Hz}$, $T_A=25^\circ\text{C}$, unless otherwise noted):

Part Name:	RCCXXH055B0	RCCXXH080B0	RCCXXH105B0	RCCXXH180B0
Window size:	55	80	105	180
Coil Circumference (mm):	197	300	378	576
Rated Current:	100A, 200A, 300A, 400A, 600A, 800A	800A, 1000A, 2000, 4000A, 5000A, 6000A	800A, 1000A, 2000, 4000A, 5000A, 6000A	800A, 1000A, 2000, 4000A, 5000A, 6000A
Current Range:	100A to 6000A etc.			
Rated Output:	5A AC			
Frequency:	50/60 Hz			
Accuracy:	$\pm 1\%$ typical at 2% to 120% of rated current (Typ 0.5%)			
Linearity Err.:	$\pm 0.2\%$ typical at (10%- 100%)			
Phase Shift:	$< 1^\circ$ (Typ 0.5°)			
Output at 0A (zero drift):	$\leq 0.05\text{A}$			
Temperature drift:	200ppm/ ° C			
Measuring resistance (RL):	$\leq 0.2\Omega$ (5VA)			
Weight(g):	980	990	995	1004
Integrator Mechanical Dimensions:	155mm*80mm*38mm			
SMPS Mechanical Dimensions:	193.5mm*98mm*38.5			
Operating Temp. of Rogowski Coil:	-20°C to 70°C			
Operating Temp. of Integrator:	-25°C to 75°C			
Terminals:	JK2EDGIK-508-3/5P			
Power Supply:	100~265V AC			
Safety:	UL2808 & CSA C22.2 No.61010-1 Pollution Degree 2, Indoor Use		1000V CATIII, Non-Service Entrance 600V CATIV, Service Entrance	
Checklist:	Rogowski coil 1 pcs Integrator 1 set SMPS 1 set			

Note1: To prevent any damage to the Flexible Probe, please pull on the coil less than 2.5kgs.

Note2: Conductor Position Err. @ with cable > 15mm between the clip with mechanism.

Note3: The current waveform being measured is Sine Wave.

Note4: Use in the condition of under 80% RH of humidity, no condensation.

China: Address: No.8, Donghuan 4th St., Jintigang, Huangjiang Town, Dongguan City, Guangdong, China Tel: +86-769-83367090 Fax: +86-769-83367590 E-mail: sales.cn@thic.net www.thic.net	Taiwan: Address: No. 9, Aly. 29, Ln. 335, Chenggong Rd., Hukou Township, Hsinchu County, Taiwan Tel: +886-3-5994440 Fax: +886-3-5902243 E-mail: top-th@thic.net www.thic.net
---	---



Thousand Hundred Industrial CO.,LTD.

Customer Part No.		Date Of Issue:	
T.H. Part No.	RCCxxxHxxxxx	T.H. Sample No.	

Mechanical Dimensions (Unit: mm):

Rogowski Coil:

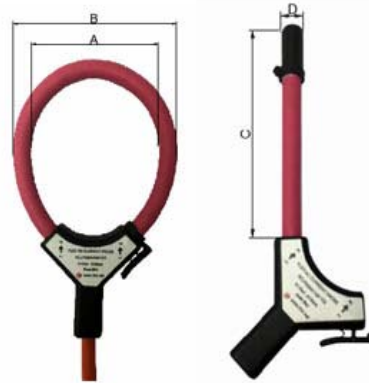
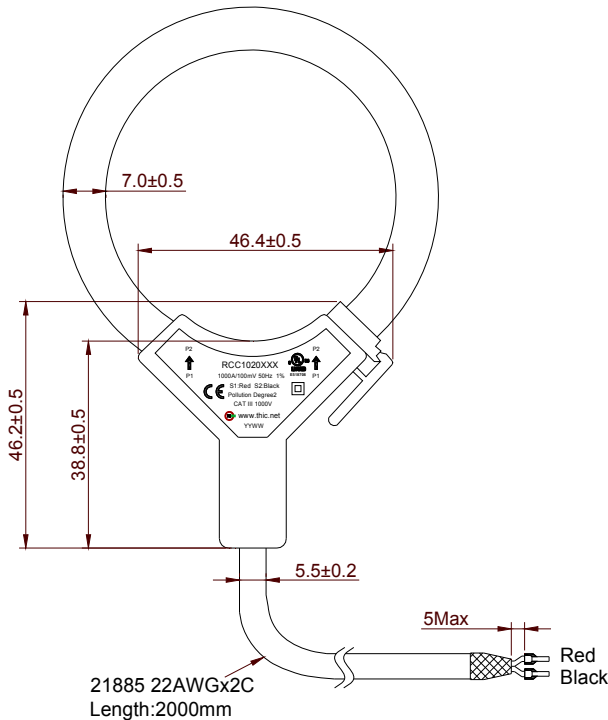

Part Name	A	B	C	D
RCC1020055B0	55	69	197	8.8
RCC1020080B0	80	94	300	8.8
RCC1020105B0	105	119	378	8.8
RCC1020180B0	180	194	576	8.8

Position sensitivity:



Part Name	RCCXXHXXXB0
Conductor Position	Typical Err.
● Adjacent to the inside coil edge	< 1%
● Adjacent to the clip together mechanism	< 2%
● Central in the coil loop	< 0.2%

Rogowski Coil Installation Guide:

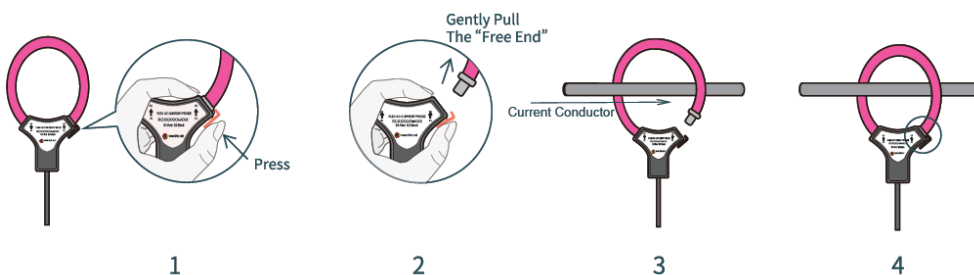

China:

Address: No.8, Donghuan 4th St., Jintigang, Huangjiang Town, Dongguan City, Guangdong, China
 Tel: +86-769-83367090 Fax: +86-769-83367590
 E-mail: sales.cn@thic.net www.thic.net

Taiwan:

Address: No. 9, Aly. 29, Ln. 335, Chenggong Rd., Hukou Township, Hsinchu County, Taiwan
 Tel: +886-3-5994440 Fax: +886-3-5902243
 E-mail: top-th@thic.net www.thic.net



Thousand Hundred Industrial CO.,LTD.

Customer Part No.		Date Of Issue:	
T.H. Part No.	RCCxxxHxxxxx	T.H. Sample No.	

Mechanical Dimensions (Unit : mm) :

5A Output Integrator:

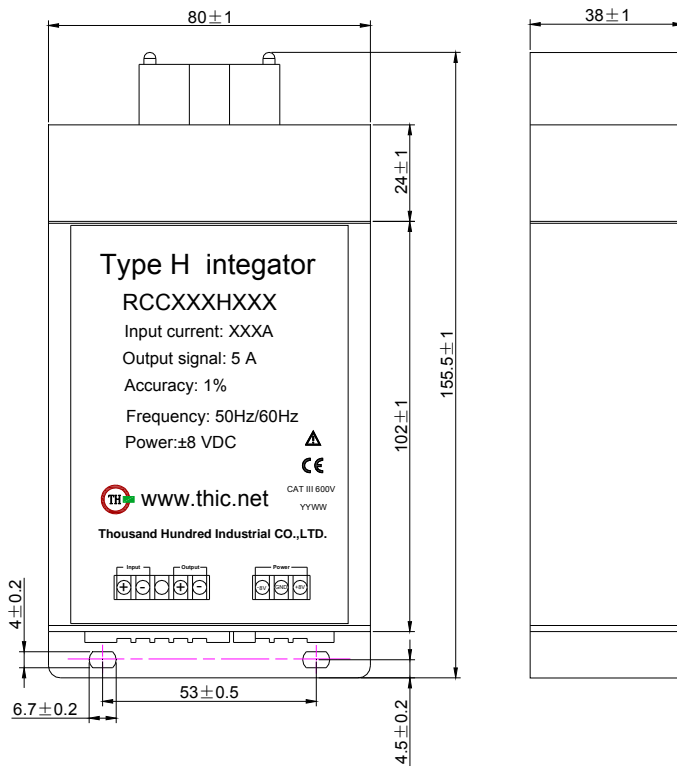

Connection:

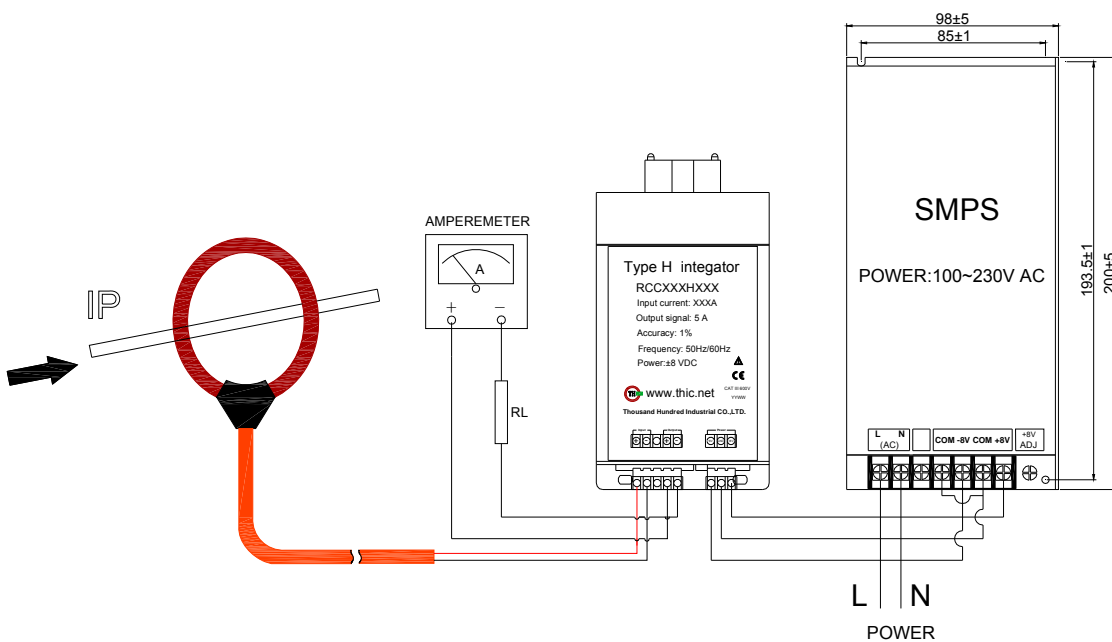

China:

Address: No.8, Donghuan 4th St., Jintigang, Huangjiang Town, Dongguan City, Guangdong, China
 Tel: +86-769-83367090 Fax: +86-769-83367590
 E-mail: sales.cn@thic.net www.thic.net

Taiwan:

Address: No. 9, Aly. 29, Ln. 335, Chenggong Rd., Hukou Township, Hsinchu County, Taiwan
 Tel: +886-3-5994440 Fax: +886-3-5902243
 E-mail: top-th@thic.net www.thic.net



Thousand Hundred Industrial CO.,LTD.

Customer Part No.		Date Of Issue:	
T.H. Part No.	RCCxxxHxxxxx	T.H. Sample No.	

Output curve:

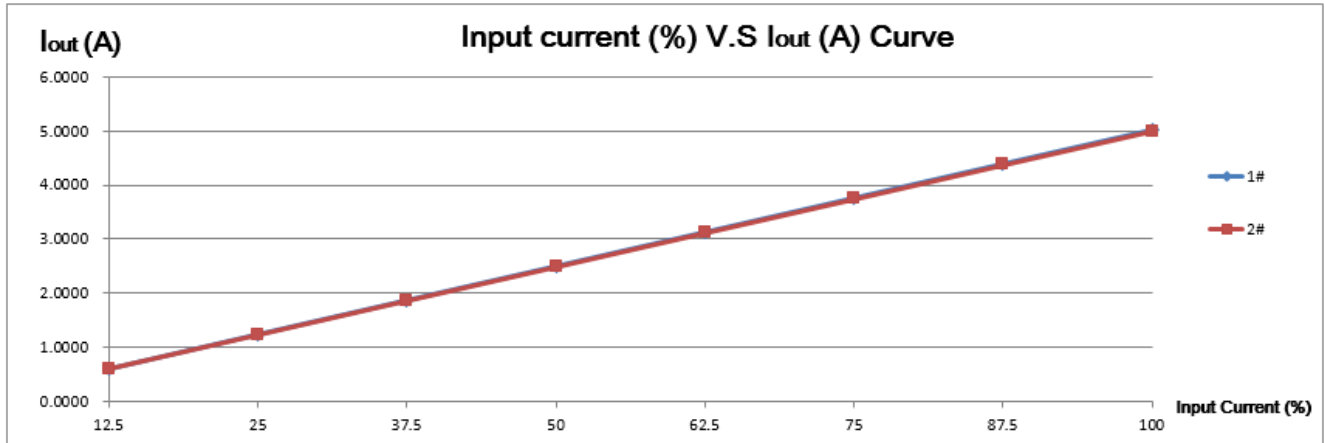

Safety and warning notes

In order to guarantee safe operation of the transducer and to be able to make proper use of all features and functions,

please read these instructions thoroughly! Safe operation can only be guaranteed if the transducer is used for the purpose it

has been designed for and within the limits of the technical specifications. Ensure you get up-to-date technical information that can be found in the latest associated datasheet under www.thic.net

- Warning:** If the equipment is used in a manner not specified by Thousand Hundred Industrial Company, the protection provided by the equipment may be impaired.
- Warning:** To reduce the risk of electric shock, always open or disconnect circuit from power-distribution system (or service) of building before installing of servicing current transformers.
- The Current transformers may not be installed in equipment where they exceed 75 percent of the wiring space of any cross-sectional area within the equipment.
- Restrict installation of current transformer in an area where it would block ventilation openings.
- Restrict installation of current transformer in area of breaker arc venting.
- Not suitable for Class 2 wiring methods.
- Not intended for connection to Class 2 equipment.
- Secure current transformer and route conductors so that they do not directly contact live terminals or bus.

China: Address: No.8, Donghuan 4th St., Jintigang, Huangjiang Town, Dongguan City, Guangdong, China Tel: +86-769-83367090 Fax: +86-769-83367590 E-mail: sales.cn@thic.net www.thic.net	Taiwan: Address: No. 9, Aly. 29, Ln. 335, Chenggong Rd., Hukou Township, Hsinchu County, Taiwan Tel: +886-3-5994440 Fax: +886-3-5902243 E-mail: top-th@thic.net www.thic.net
---	---